

2017 Mexico Earthquake: Schools Assessments Summary

Date: April 2019- Present

Assessors: Daniel Tejedor, Alba Gonzalez & Andrew Sharp



Mexico Quick Facts

- Official Name: **Estados Unidos Mexicanos** (United Mexican States).
- Mexico has a total population of **119,938,473 hab.** (INEGI, 2015) and total area of **1,972,550** square kilometers.
- Mexico is a federation comprising 31 **states** and a **special federal entity** that is also its capital and **most populous city**: Mexico City (CDMX).
- In September 2017, 3 earthquakes of greater than 6.0 magnitude hit the country:



Mexico Quick Facts

- The earthquakes mainly affected 8 states: Mexico City, Chiapas, State of Mexico, Guerrero, Morelos, Oaxaca and Puebla.
 - About **171,925** homes were affected (<http://transparencia.sedatu.gob.mx/#>)
 - **20,210** schools were damaged, and about **577** need total reconstruction. (SEP, June 2018)

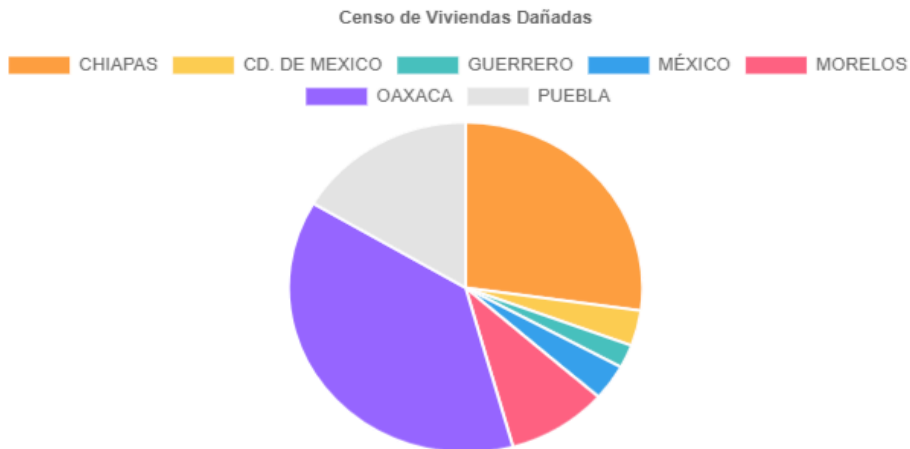

Percentage of homes affected by State
<http://transparencia.sedatu.gob.mx/#>

Overview of Assessment Process



- 1 - Contacted the State Educational Infrastructure Government from Oaxaca (IOCIFED), Puebla (CAPCEE), Morelos (INEIEM) and Chiapas (INIFECH) and requested:
 - list of the school with needs
 - meeting with the director of each state

- 2 - Contacted the Federal Education Infrastructure Government (INIFED) and requested:
 - list of the school with needs
 - meeting with the director of each state

- 3 - Analyzed the information, and using the new criteria of localitation, develop list of schools to be assessed.

- 4 - Remote assessment with school contacts to develop a better understanding the real needs of each school from the list.

- 5 - Reviewed data from remote assessments and created list of schools that meet criteria.

- 6 - Physical assessment of selected schools for technical assessment of damage and need

Puebla

- Preschool Siervo de la Nación



Transportation to Siervo de la Nación - Puebla

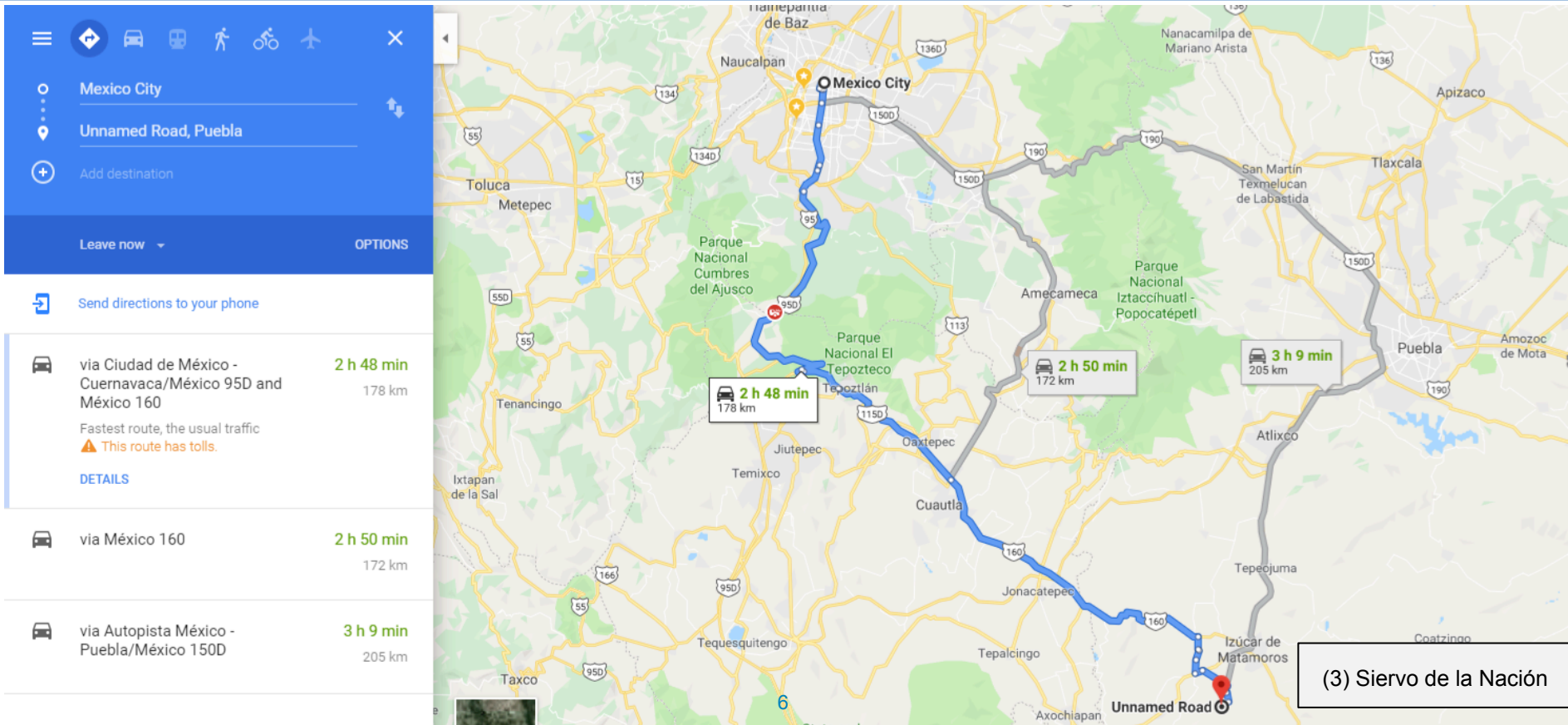

Puebla - Prospective Program 3

- Preschool Siervo de la Nación



- **Scope:** Demolition. New build 3 room building with; 2 classrooms, 1 office/ toilets.
- **Timeline:** 4-5 months
- **Grades:** Kindergarten
- **Students:** 47 (No change in number of students before & after disaster)
- **Pre-disaster Status:** 2 classrooms, 1 art/ multipurpose room, 1 office/ toilets
- **Current Status:** 2 transportable trailer classrooms and temporary toilets
- **Damage:** 4 room building is total damage (2 classrooms, 1 art/ multipurpose room, 1 office/ toilets). Should be demolish and build again
- **Land Ownership Status:** School has the land title
- **Political status:** without problems
- **Donors/partners:** Don't have any financial assistance yet
- **Key Risk:** Start the foundation in the raining season

\$300k

Puebla - Prospective Program 3

- Preschool Siervo de la Nación ([Photos & Videos](#))



Puebla - Prospective Program 3

- Preschool Siervo de la Nación



This is an illustrative layout of the actual preschool. The proper layout will be defined after the soil/topographic studies recommendations

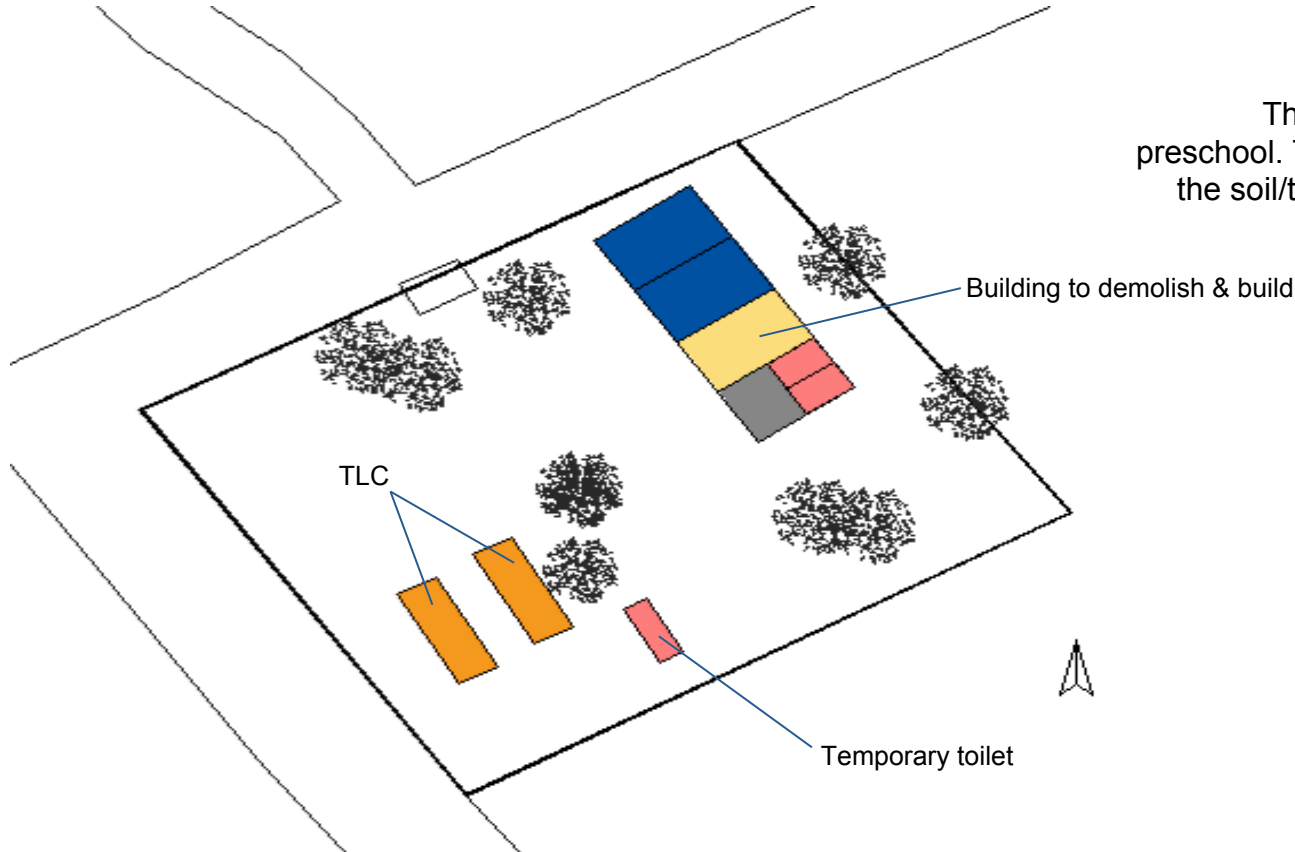

School complex

2 damage classrooms

1 library

1 office

1 female and 1 male WC

2 TLC

Layout of 3 room block with office and WaSH

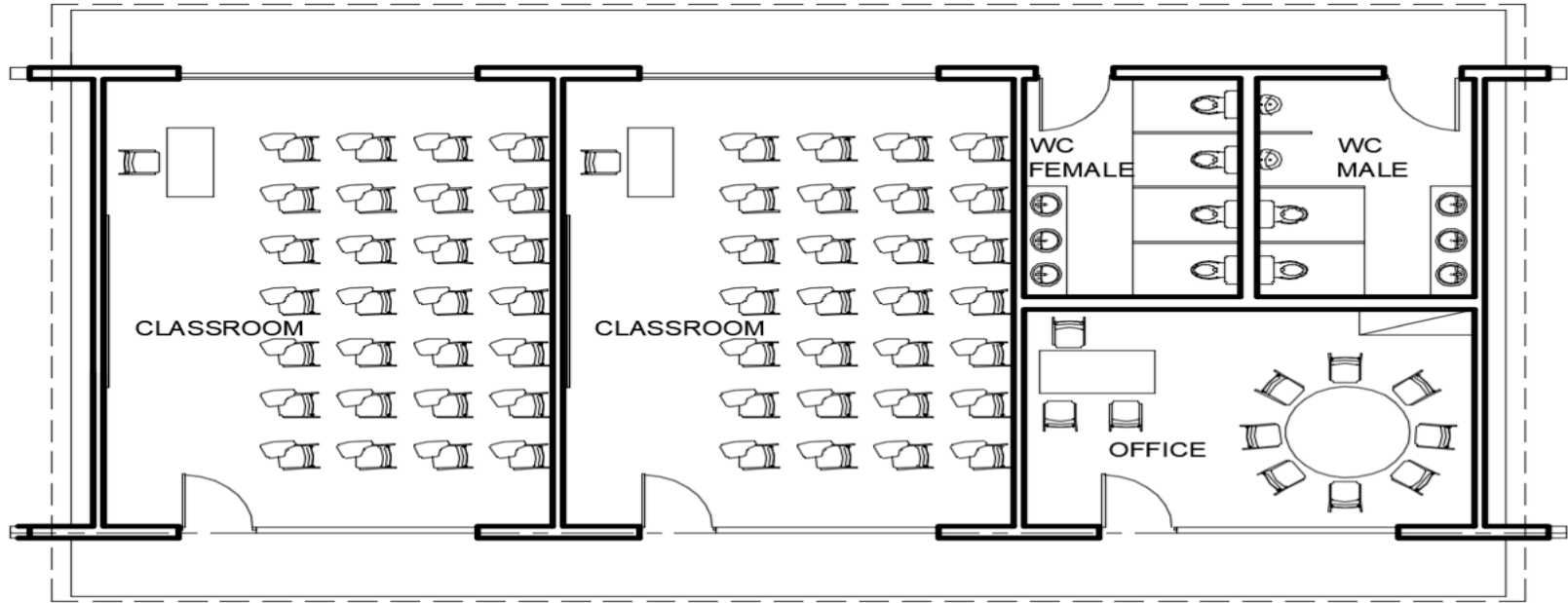

Proposed Layout:

Regular sized 2 classrooms with the 3rd room split in half to provide the space for the office and the WaSH.

Budget for Siervo de la Nación



Scope	New build 3 room building 2 classrooms, 1 office/ toilets.
Number of volunteers	20
Pre-disaster students	47
Current Students	47
Grades	ECD
Timeline (months)	4.5
School	\$150,000
Site Preparation	\$8,000
School Repair	
Furniture	\$10,000
WaSH (Sanitation System, Toilets)	\$20,000
Playground	\$5,000
Construction Budget	\$193,000
Operations Budget	\$63,000
Operations Labour	\$45,000
TOTAL BUDGET	\$301,000